

# A living experience like no other

Wellington's most sought-after residential address... a place where the apartments are as breathtaking as the views.



Taking full advantage of their unparalleled position, every one of the superb and generously proportioned premium apartments at Clyde Quay Wharf capitalises on the inner-city wharf location, spectacular views and incredible sense of proximity to the natural harbour environment.

The apartment interiors at this landmark finger wharf offer not only exquisite contemporary design, but also a standard of quality and finish like no other.

Each premium apartment offers spacious entertaining and kitchen areas; private bedrooms with walk-in wardrobes; luxurious bathrooms; and generous balconies to allow for a seamless indoor-outdoor flow, to make the most of the sun, light and views.

The extensive resident amenities include a concierge service, 14-seat luxury movie theatre, full-service gymnasium, business centre and meeting room together with generous car parking and bike storage areas.

Apartments are accessed via eight individually-designed lobbies, which feature custom-designed finishes and deliver an intimate environment in this unique wharf setting.

A superb mix of complementary activities at wharf level are now confirmed and feature the iconic White House restaurant, a new fresh Mojo eatery concept, Saatchi and Saatchi advertising agency and HealthFit Collective, a new health and fitness operation.

There are a limited number of apartments available consisting of a mix of two- and three-bedroom residences, with prices starting from \$1.375 million. These remaining apartments feature new layouts that have been developed during the project and informed by existing owners.

Here is a place to enjoy all that Wellington has to offer.

## Features of Clyde Quay Wharf living



- > Two- and three- bedroom apartments available.
- > Outstanding sun, views, privacy and natural light.
- > High ceilings in all apartments.
- > Second living media/study dens.
- > Car parks with direct lift access.
- > Large separate storage areas.
- > On-site concierge, movie theatre, gymnasium and business centre.



- > New White House Restaurant.
- > Mojo's new concept eatery and cafe.
- > Saatchi & Saatchi.
- > HealthFit Collective.
- > Heritage features throughout wharf.

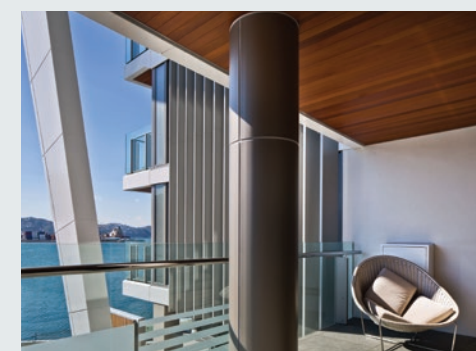

- > Construction completed July 2014.
- > Landmark architecture designed with marine-grade materials.
- > Premium standard of glazing, acoustic and building performance systems.
- > Constructed by LT McGuinness.
- > 200 new concrete piles delivering seismic performance in excess of 100% of NBS.

## APARTMENTS NOW AVAILABLE FOR VIEWING

Prices start from \$1.375 million for a two-bedroom residence including one car park and a large separate storage area.

To make an appointment to view apartments, contact us on:

Tel: 04 805 0022 Email: [enquiry@clydequaywharf.co.nz](mailto:enquiry@clydequaywharf.co.nz)

[www.clydequaywharf.co.nz](http://www.clydequaywharf.co.nz)

